

brand	MEP
-------	------------

date	FEB/03	SHEET 1/3
------	--------	-----------

Model

ER 653 SP

Product number

953876129

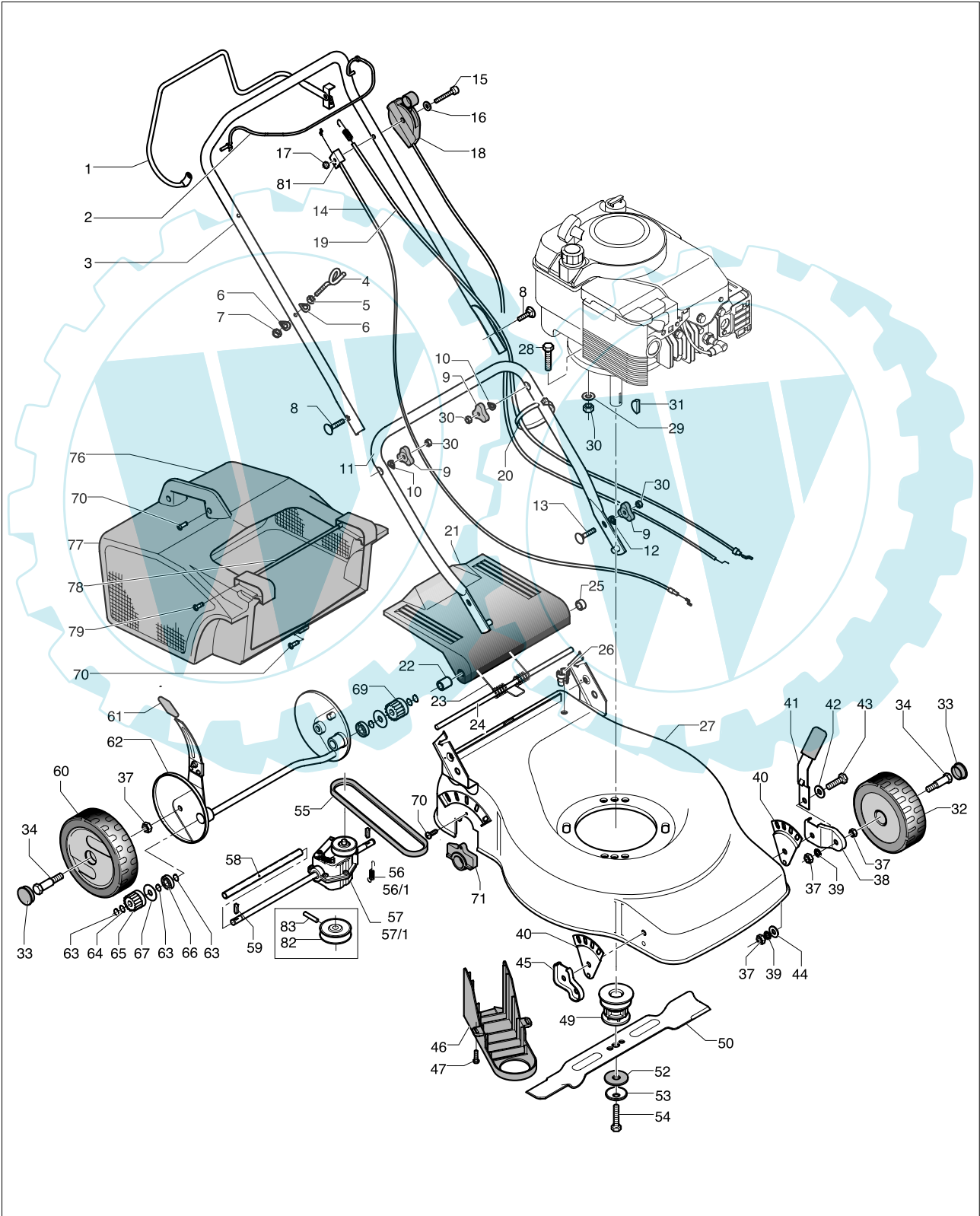

brand	MEP
-------	------------

date	FEB/03	SHEET 2/3
------	--------	-----------

Model

ER 653 SP

Product number

953876129

Pos.	PN ELX	PN MEP	DESCRIPTION	Q.ty	NOTE
1	531205616	10135883	clutch lever	1	
2	531205618	10135893	lever	1	
3	531206211	10155373	upper handle	1	
4	531205169	10121470	cable hook	1	
5	531207165	10501200	nut	1	M6 H6 UNI 5587-6S-ZB
6	531204961	10115900	washer	2	6,5E
7	531208491	20281800	nut	1	M6H8UNI7473ZB
8	531207089	10402401	screw	2	TTSQ M8x50 TF ZB
9	531204923	10114303	knob	4	
10	531207090	10402402	washer	2	8,5
11	531205711	10140053	handle lowere	1	
12	531204922	10114200	washer	2	8x16x1,5 ZB
13	531204921	10114100	screw	2	TTSQ M8x25 T.FIL. ZB
14	531205191	10121610	cable	1	B&S - 1097/148
15	531206212	10155420	screw	1	TE M5x60 UNI 5739-4.8 T.F
16	531206666	10284700	washer	1	5/15/1,5 ZB
17	531205213	10121890	nut	1	M5 DIN 6923
18	531206210	10155360	accelerador	1	B&S 1430/48
19	531206191	10155290	clutch cable	1	rid-plastica
20	531205581	10135600	clamp	2	160X4,5
21	531205486	10135072	deflector	1	
22	531205733	10140223	spacer	1	H.15
23	531206180	10155190	spring	1	
24	531205731	10140190	tie rod	1	
25	531205732	10140213	spacer	1	H.5
26	531205557	10135413	cable lock	1	
27	531204669	09155332	deck	1	
28	531205196	10121700	screw	3	TE M8x35 UNI 5739-8,8-ZB
29	531207981	20106200	washer	4	D.8E DIN 6798
30	531207982	20106300	nut	7	M8 H8 UNI 5587-6S ZB
31	531204907	10100900	key	1	4x6,5 UNI6606 WODRUF
32	531205031	10120074	wheel	2	D.170/13 TAC
33	531204936	10114804	plug	4	
34	531205042	10120090	screw	4	
37	531207978	20101700	nut	8	M10 H8 UNI 5588-6S ZB
38	531204915	10107302	bearing	1	DX
39	531208974	30102100	washer	4	
40	531205925	10146010	support	2	
41	531204913	10107203	rod	2	
42	531206020	10146530	washer	2	UNI 8840 B12 (13/24/1)
43	531204912	10107100	screw	2	
44	531207989	20113000	washer	2	10x30x2,5
45	531204914	10107301	bearing	1	SX

brand	MEP
-------	------------

date	FEB/03	SHEET 3/3
------	--------	-----------

Model

ER 653 SP

Product number

953876129

Pos.	PN ELX	PN MEP	DESCRIPTION	Q.ty	NOTE
46	531206175	10155083	belt housing	1	
47	531207856	10831800	screw	3	TEFR 5x10 ZB
49	531206169	10155040	support	1	
50	531211646	10141770	blade	1	
52	531207243	10531700	washer	1	FRIZ.17,2x50x1,5+0,1
53	531207237	10530900	washer	1	11x50x2,5
54	531208008	20120580	screw	1	TE 3/8 UNFx37-8,8 1/2F ZB
55	531206176	10155100	belt	1	Z29 1/2 (10X750) 3L310
56	531205216	10121920	spring	1	RID-PLASTICA
57	531204755	09767400	reducer	1	RID-PLASTICA
58	531207697	10766503	spacer tube	1	
59	531205108	10121160	key	2	"S" 5x5(-0,05)x19,2 DIAG
60	531205624	10136074	wheel	2	D.210
61	531207986	20107203	sheating	1	
62	531206178	10155150	rear axle	1	
63	531208772	20655800	seeger	6	D.12E DIN 471
64	531208859	20761300	washer	2	D.12,4x17x0,3
65	531205045	10120160	pinion	1	DX
66	531208778	20657600	ball-bearing	2	D.12/28/8 6001/2RS
67	531207847	10831200	washer	2	D.12/34/0,7 ZB
69	531205046	10120170	pinion	1	SX
70	531208216	20135720	screw	5	TCTC2F D5x16 AC
71	531205944	10146093	support	2	
76	531208207	20135323	left side grass catcher	1	
77	531208203	20135313	right side grass catcher	1	
78	531205547	10135330	tie rod	1	D.8 x 330
79	531207937	10878000	screw	2	TCTC 3,9x16
81	531208043	20121983	cable bearing	1	
82	531208899	20768203	gear pulley	1	
83	531207703	10768400	resilient pin	1	